



21300 W 8 Mile Rd.
Southfield, MI 48075-5638

ENTRY-FIT™ "K2A-Series" ADJUSTABLE STEEL DOOR FRAME Utilizing a Steel Door Panel "IMPACT"

GENERAL NOTES

1. This product has been evaluated and is in compliance with the 6th Edition (2017) Florida Building Code (FBC) structural requirements including the "High Velocity Hurricane Zone" (HVHZ).
2. Product anchors shall be as listed and spaced as shown on details. Anchor embedment to base material shall be beyond wall dressing or stucco.
3. When used in the "HVHZ" this product complies with Section 1626 of the Florida Building Code and does not require an impact resistant covering.
4. When used in areas outside of the "HVHZ" requiring wind borne debris protection, this product complies with FBC Sections 1609.1.2 & R301.2.1.2 and does not require an impact resistant covering. This product meets missile level "D" and includes Wind Zone 4 as defined in ASTM E 1996 and FBC Sections 1609.1.2.2 & R301.2.1.2.1.
5. This product has been tested with the door panels as specified in this approval. Substitution of a similar product may be approved for use by the local Authority Having Jurisdiction. In all cases, the steel door used must possess a comparable current Florida Statewide product approval. The door panel size and design pressure (DP) rating shall not exceed the sizes and DP ratings shown in this approval or the steel side hinged swing door approval being used.
6. Site conditions that deviate from the details of this drawing require further engineering analysis by a licensed engineer or registered architect.
7. Configurations utilizing the high-dam outswing bump threshold (item #30) meet water infiltration requirements for the "HVHZ".
8. Configurations utilizing inswing threshold (item #31), outswing threshold (item #32) and the ADA threshold (item #33), do not meet the water infiltration requirements for the "HVHZ". These units shall be installed only in non-habitable areas or at habitable locations protected by an overhang or canopy such that the angle between the edge of canopy or overhang to sill is less than 45 degrees.
9. When used in the "HVHZ", steel must be protected as specified in FBC Section 2222.6.

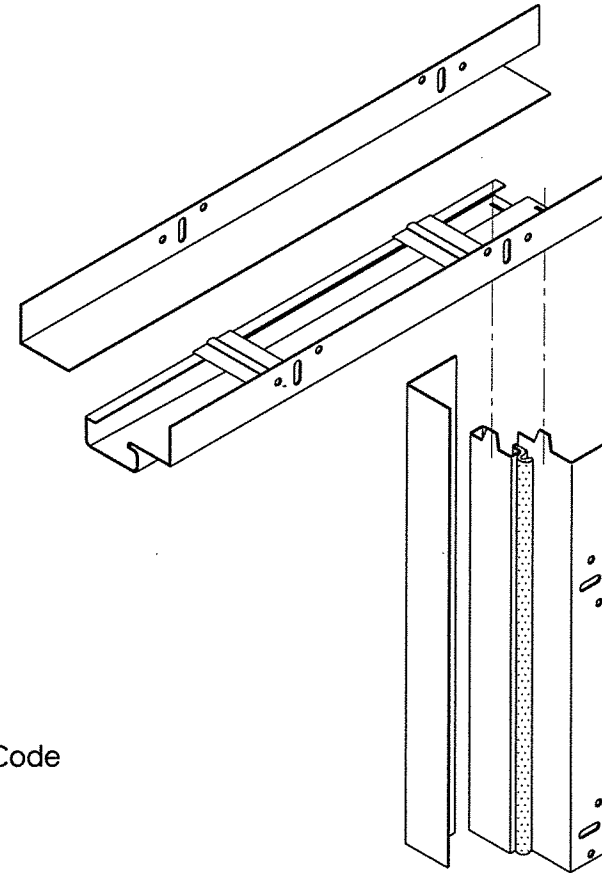

ADJUSTABLE STEEL DOOR FRAME
K2A-Series

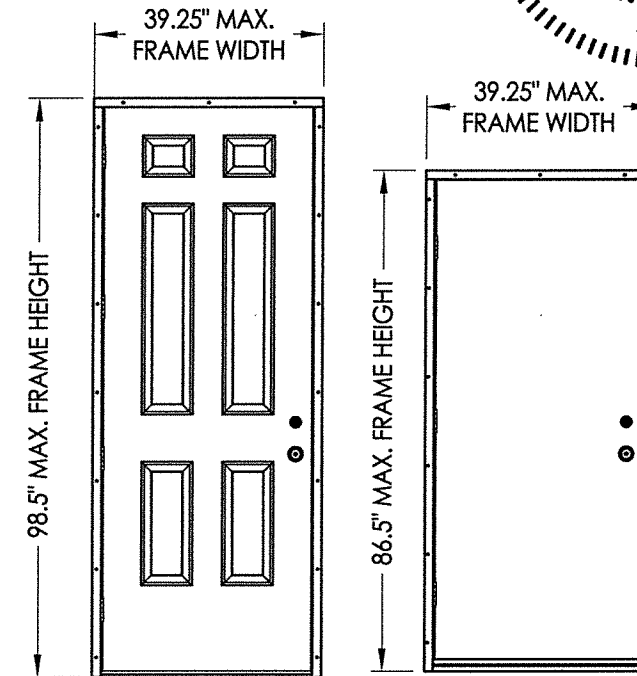

INSWING OR OUTSWING

| DOOR PANEL | MAX. OVERALL FRAME DIMENSION | DESIGN PRESSURE (PSF) INSWING | | DESIGN PRESSURE (PSF) OUTSWING | |
|------------|------------------------------|-------------------------------|----------|--------------------------------|----------|
| | | POSITIVE | NEGATIVE | POSITIVE | NEGATIVE |
| JELD-WEN | 39.25" X 86.5" | + 75.0 | - 75.0 | + 65.0 | - 75.0 |
| JELD-WEN | 39.25" X 98.5" | + 60.0 | - 70.0 | + 60.0 | - 60.0 |

| TABLE OF CONTENTS | |
|-------------------|--|
| SHEET# | DESCRIPTION |
| 1 | Typical elevations, design pressures & general notes |
| 2 | Door panel details |
| 3 | Door panel details |
| 4 | Corner detail |
| 5 | Elevations |
| 6 | Horizontal cross sections |
| 7 | Vertical cross sections |
| 8 | Frame & buck anchoring (7'-0" door) |
| 9 | Frame & buck anchoring (8'-0" door) |
| 10 | Bill of materials and components |

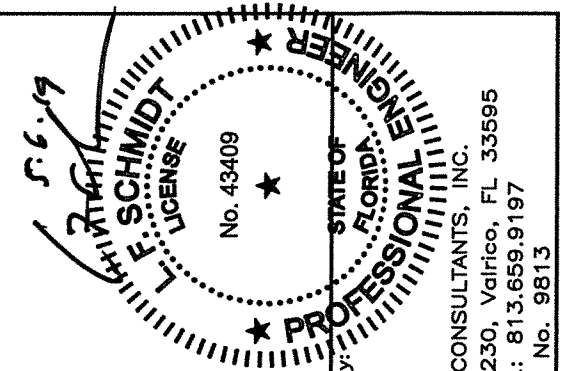

Documents Prepared By:
Lyndon F. Schmidt
P.E. No. 43409

RW BUILDING CONSULTANTS, INC.
P.O. Box 230, Valrico, FL 33595
Phone No.: 813.659.9197
FBPE C.A. No. 9813

PRODUCT: IDP STEEL FRAME (K2A-SERIES)
PART OR ASSEMBLY: TYPICAL ELEVATION, DESIGN PRESSURE & GENERAL NOTES

| NO. | DATE | REVISIONS |
|-----|---------|------------------------------|
| 3 | 5/06/19 | ADD SILL ANCHORING OPTION |
| 2 | 4/17/18 | CLARIFY FRAME ANCHORING |
| 1 | 9/26/17 | UPDATE TO 6TH ED. (2017) FBC |

DATE: 10/23/15
SCALE: N.T.S.
DWG. BY: JK
CHK. BY: LFS
DRAWING NO.: FL-14512.4
SHEET 1 OF 10

R:\Clients\IDP PERMANENTVA - Florida Product Approvals\FL-14512\C - Drawings\FL-14512 (2017)\FL-14512.4.dwg, FL-14512.4

© 2015 R.W. BUILDING CONSULTANTS INC.

R:\Clients\IDP PERMANENT\A - Florida Product Approvals\FL-14512C - Drawings\FL-14512 (2017)\FL-14512.4.dwg, 2.1

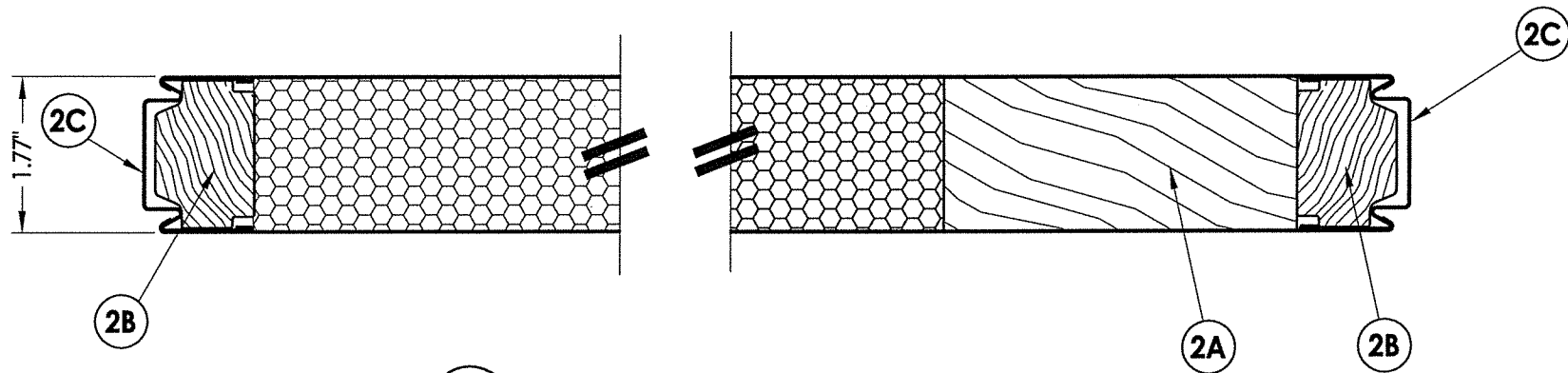

1
2 HORIZONTAL CROSS SECTION

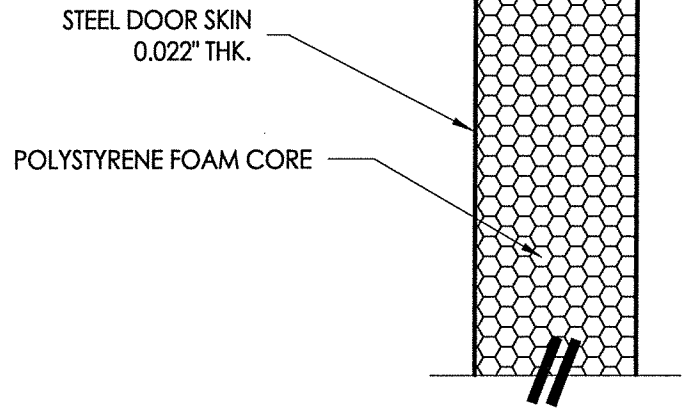

2
2 VERTICAL CROSS SECTION

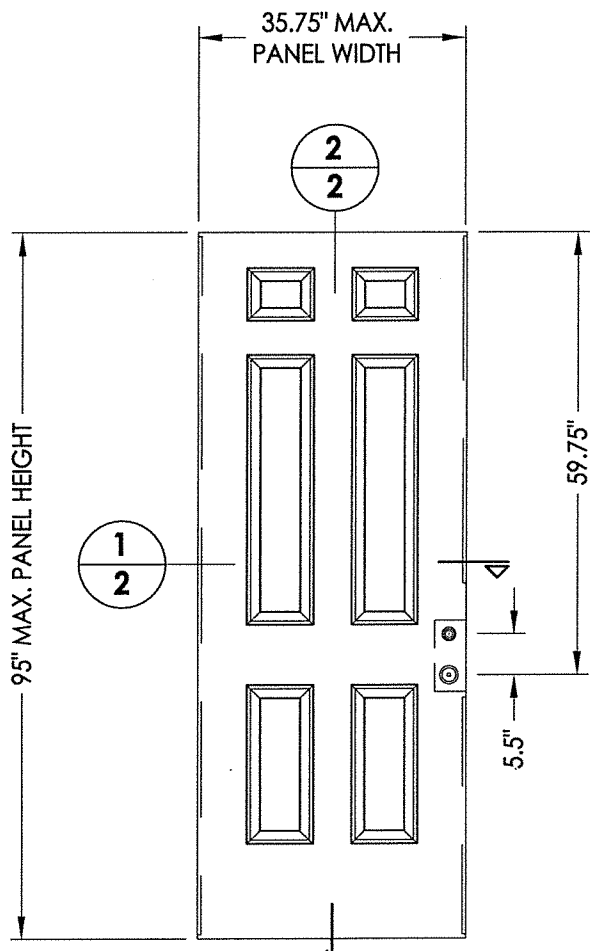

40 8' - DOOR PANEL
Steel (JELD-WEN)

STEEL DOOR SKIN: MIN. 0.022" THK.
GALVANIZED STEEL (Fy = 48,000 PSI MIN.)

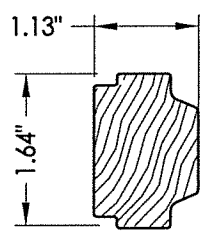

2B STILE REINFORCEMENT
Wood

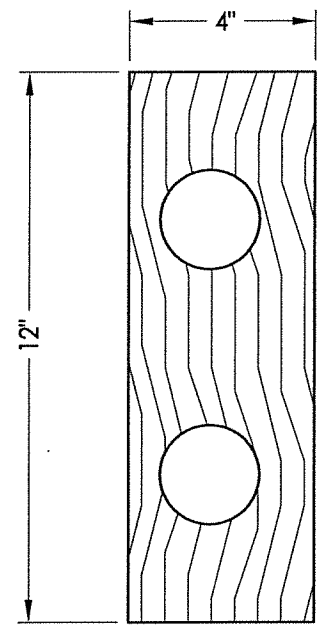

2A LOCK BLOCK
Wood

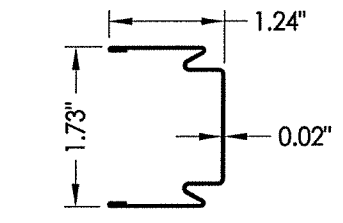

2C LATCH / HINGE STILE
Steel

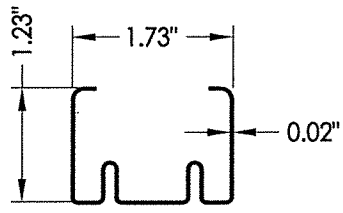

2D BOTTOM RAIL
Steel

STEEL DOOR SKIN
0.022" THK.

POLYSTYRENE FOAM CORE

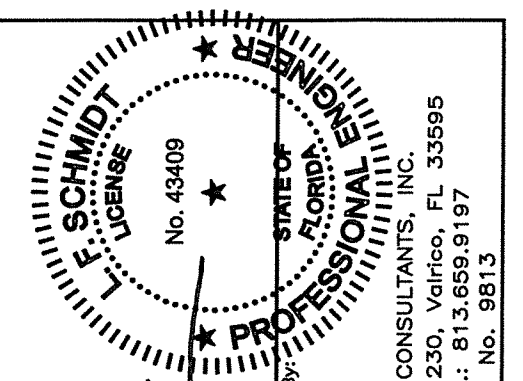

LFS
S.G.P

Documents Prepared By:
Lyndon F. Schmidt
P.E. No. 43409

RW BUILDING CONSULTANTS, INC.
P.O. Box 230, Vairico, FL 33595
Phone No.: 813.659.9197
FBPE C.A. No. 9813

| | |
|-------------------|---------------------------------|
| PRODUCT: | IDP STEEL FRAME (K2A-SERIES) |
| PART OR ASSEMBLY: | DOOR PANEL DETAILS |

| NO. | DATE | BY |
|-----|---------|-----|
| 3 | 5/06/19 | LFS |
| 2 | 4/17/18 | LFS |
| 1 | 9/26/17 | JK |

| | |
|--------------|------------|
| DATE: | 10/23/15 |
| SCALE: | N.T.S. |
| DWG. BY: | JK |
| CHK. BY: | LFS |
| DRAWING NO.: | FL-14512.4 |
| SHEET | 2 of 10 |

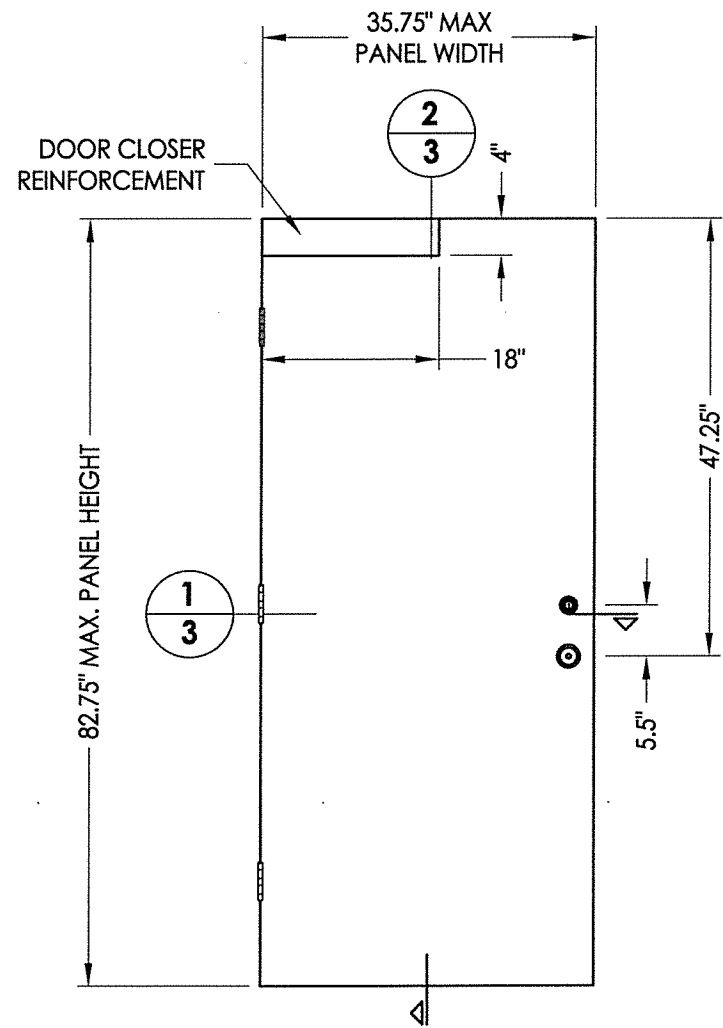

50 7' - DOOR PANEL
Steel (JELD-WEN)

STEEL DOOR SKIN: MIN. 0.022" THK.
GALVANIZED STEEL (Fy = 48,000 PSI MIN.)

1 HORIZONTAL CROSS SECTION

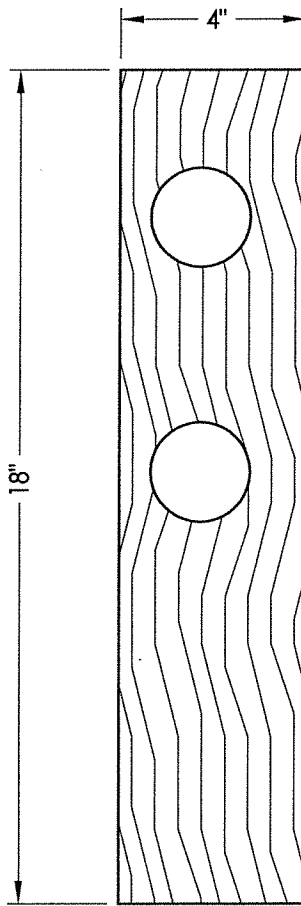

3A LOCK BLOCK
Wood

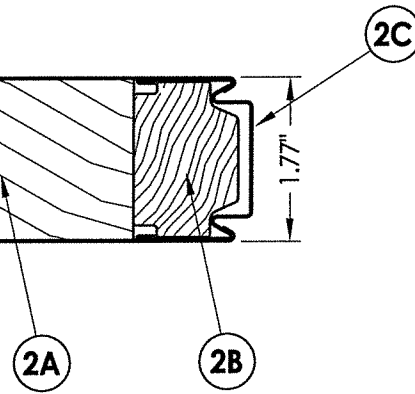

3B STILE REINFORCEMENT
Wood

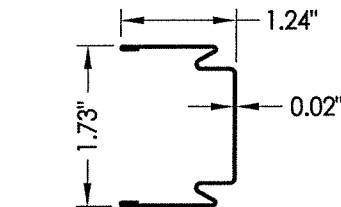

3C LATCH / HINGE STILE
Steel

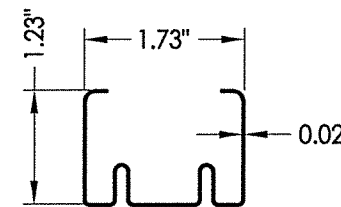

3D BOTTOM RAIL
Steel

2 VERTICAL CROSS SECTION

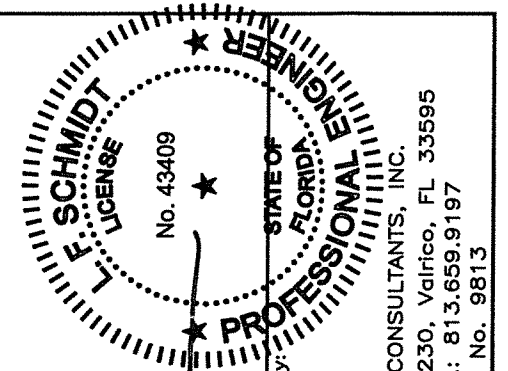
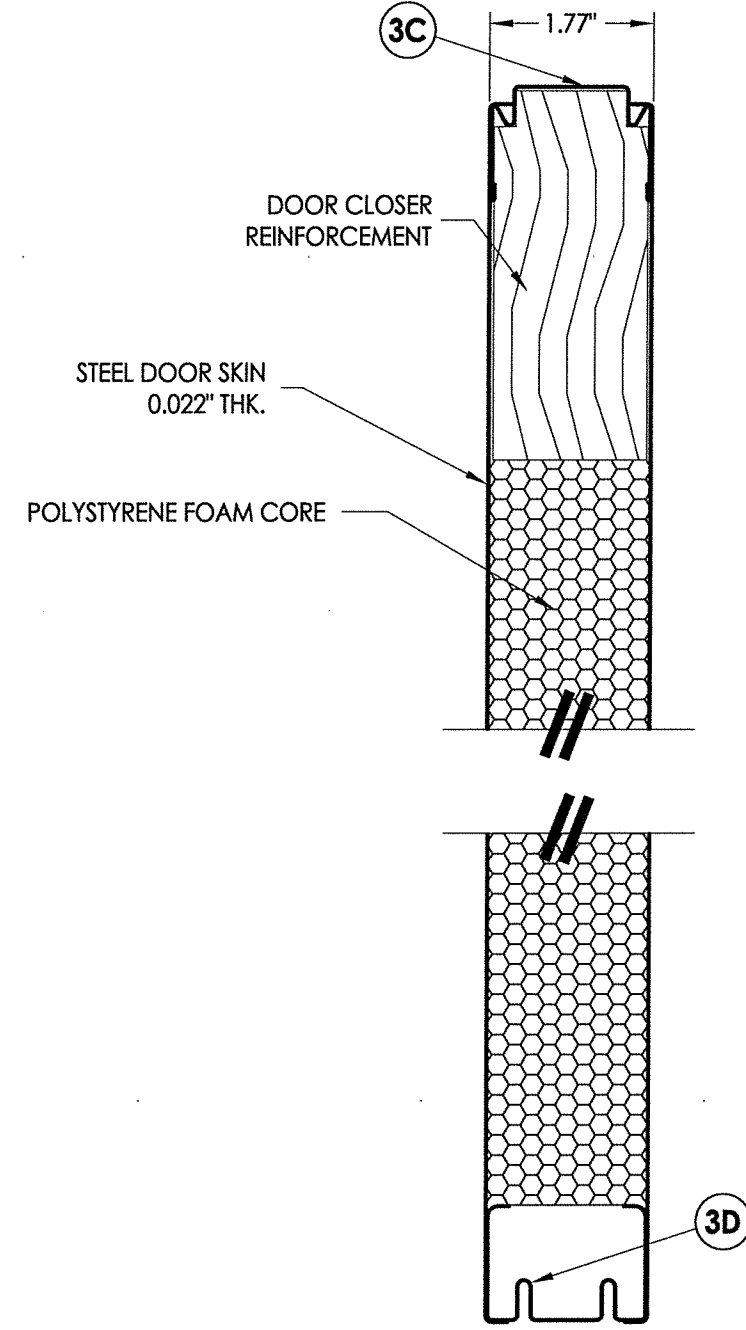

LFS
5-6-19

Documents Prepared By:
Lyndon F. Schmidt
P.E. No. 43409

RW
BUILDING CONSULTANTS, INC.
P.O. Box 230, Valrico, FL 33595
Phone No.: 813.659.9197
FBPE C.A. No. 9813

| | | | |
|--------------------------|---------|--------------------|------------------------------|
| PRODUCT: | | IDP | |
| STEEL FRAME (K2A-SERIES) | | DOOR PANEL DETAILS | |
| PART OR ASSEMBLY: | | REVISIONS | |
| NO. | DATE | BY | |
| 3 | 5/06/19 | JK | ADD SILL ANCHORING OPTION |
| 2 | 4/17/18 | LFS | CLARIFY FRAME ANCHORING |
| 1 | 9/26/17 | JK | UPDATE TO 6TH ED. (2017) FBC |
| DATE: 10/23/15 | | | |
| SCALE: N.T.S. | | | |
| DWG. BY: JK | | | |
| CHK. BY: LFS | | | |
| DRAWING NO.: FL-14512.4 | | | |
| SHEET 3 OF 10 | | | |

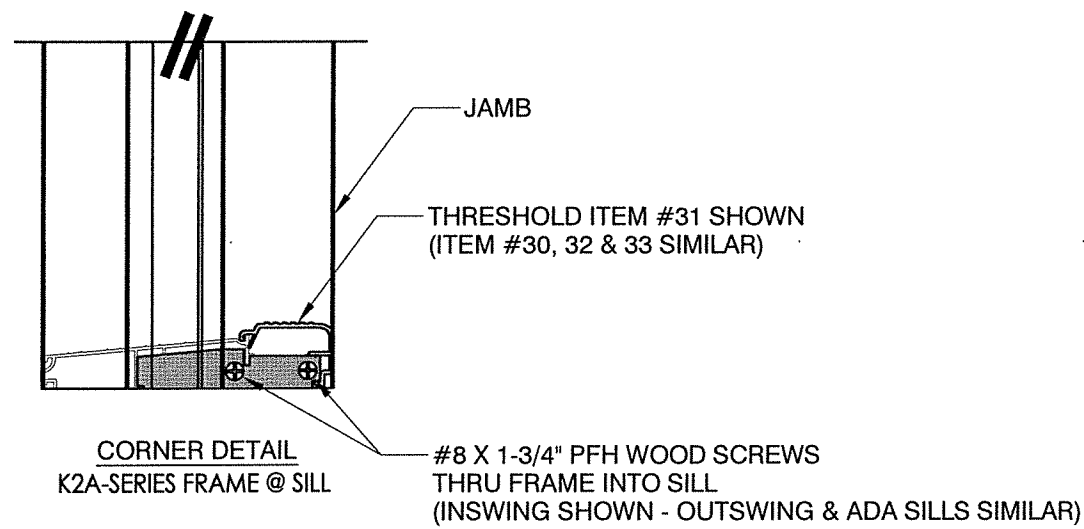

CORNER DETAIL
K2A-SERIES FRAME @ SILL

#8 X 1-3/4" PFH WOOD SCREWS
THRU FRAME INTO SILL
(INSWING SHOWN - OUTSWING & ADA SILLS SIMILAR)

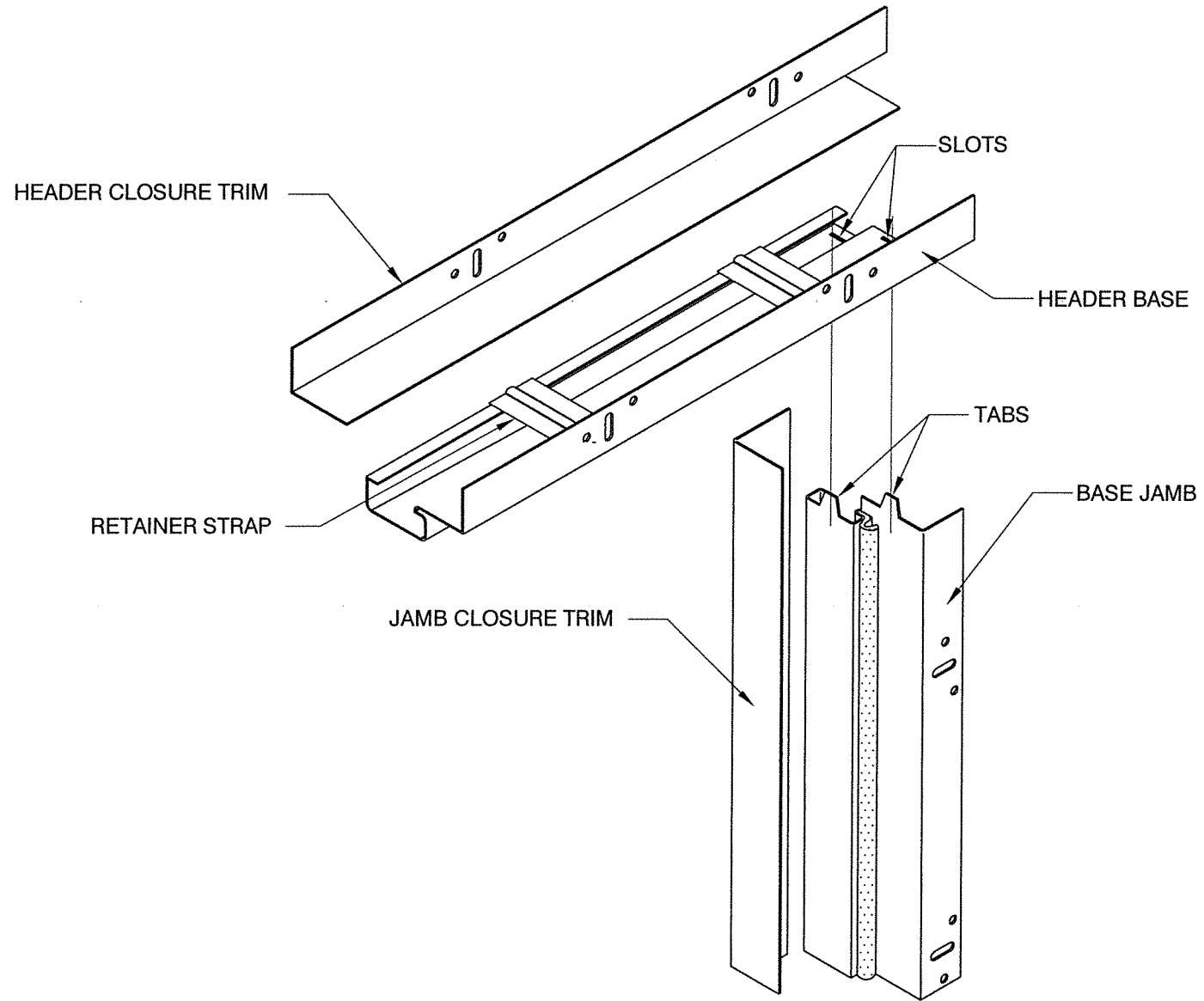

CORNER DETAIL
IDP ENTRY-FIT™ ADJUSTABLE
STEEL DOOR FRAME (K2A-SERIES)

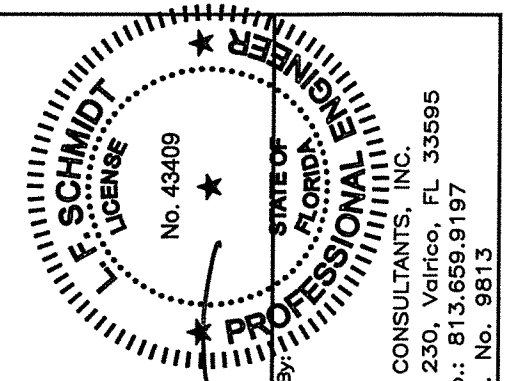

Documents Prepared By:
Lyndon F. Schmidt
P.E. No. 43409

RW BUILDING CONSULTANTS, INC.
P.O. Box 230, Valrico, FL 33595
Phone No.: 813.659.9197
FBPE C.A. No. 9813

| | | | |
|--------------------------|------------|---------------|------------------------------|
| PRODUCT: | | IDP | |
| STEEL FRAME (K2A-SERIES) | | | |
| PART OR ASSEMBLY: | | CORNER DETAIL | |
| NO. | DATE | BY | REVISIONS |
| 3 | 5/06/19 | LFS | ADD SILL ANCHORING OPTION |
| 2 | 4/17/18 | LFS | CLARIFY FRAME ANCHORING |
| 1 | 9/26/17 | JK | UPDATE TO 6TH ED. (2017) FBC |
| DATE | 10/23/15 | | |
| SCALE: | N.T.S. | | |
| DWG. BY: | JK | | |
| CHK. BY: | LFS | | |
| DRAWING NO.: | FL-14512.4 | | |
| SHEET | 4 | OF | 10 |

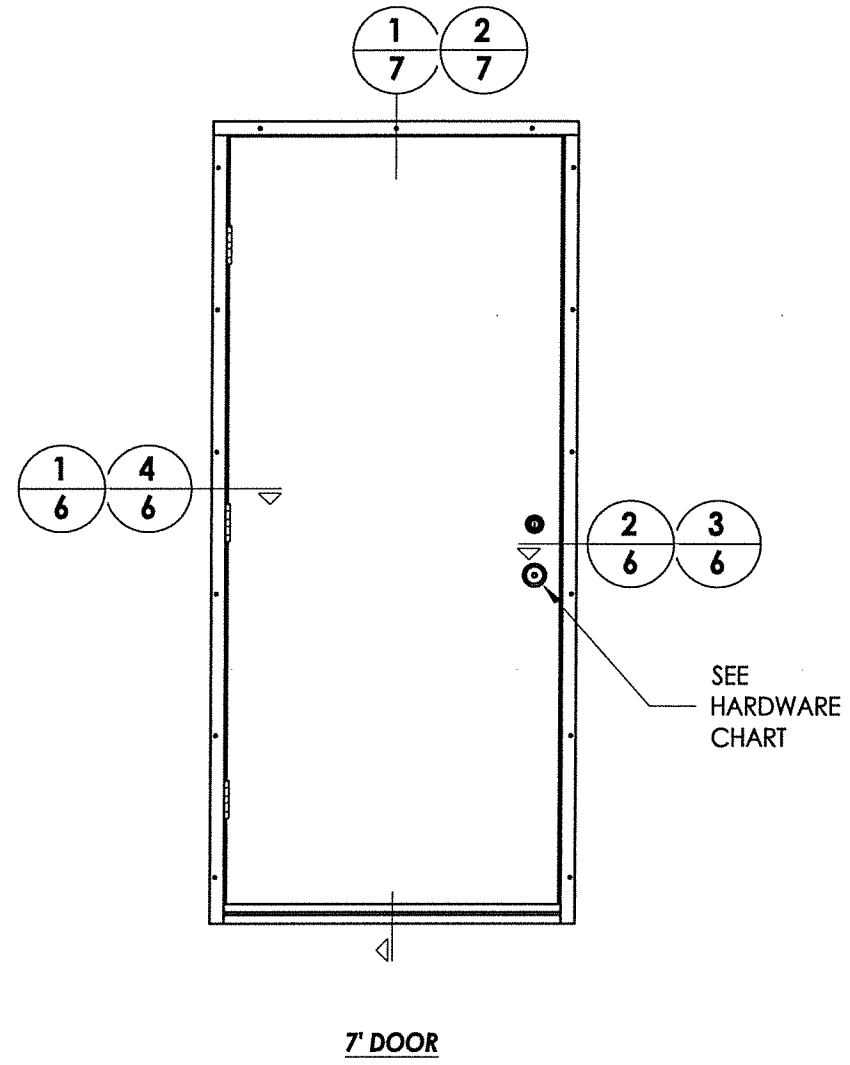
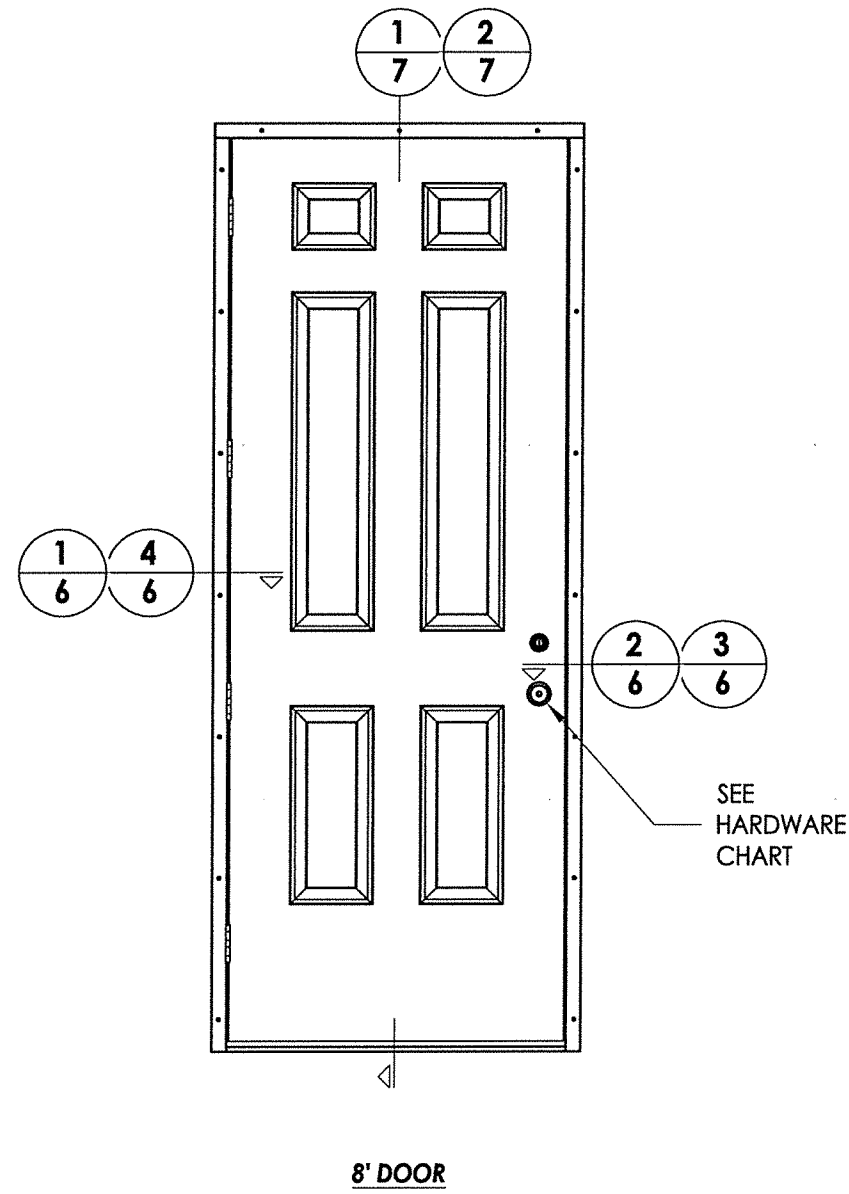

| HARDWARE CHART | |
|----------------|--|
| MANUFACTURER | MODEL |
| KWIKSET | LOCK: SIGNATURE SERIES DEADBOLT: SIGNATURE SERIES (980) |
| SCHLAGE | LEVER: "F" SERIES (F51) DEADBOLT: "B" SERIES (B300) |

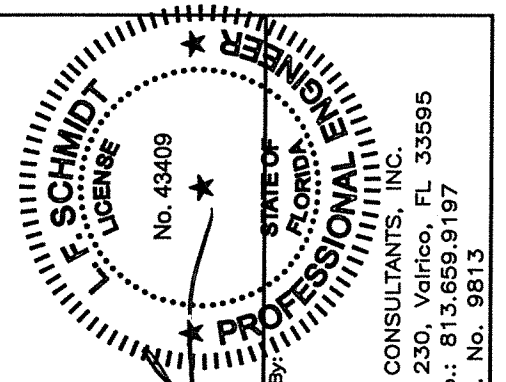

LFS
5.6.17

Documents Prepared By:
Lyndon F. Schmidt
P.E. No. 43409

RW

BUILDING CONSULTANTS, INC.
P.O. Box 230, Valrico, FL 33595
Phone No.: 813.659.9197
FBPE C.A. No. 9813

| | |
|----------|------------------------------|
| PRODUCT: | IDP STEEL FRAME (K2A-SERIES) |
| | PART OR ASSEMBLY: |
| | ELEVATIONS |

| NO. | DATE | REVISIONS |
|-----|---------|------------------------------|
| 3 | 5/06/19 | ADD SILL ANCHORING OPTION |
| 2 | 4/17/18 | CLARIFY FRAME ANCHORING |
| 1 | 9/26/17 | UPDATE TO 6TH ED. (2017) FBC |
| | | BY |

| | |
|--------------|------------|
| DATE: | 10/23/15 |
| SCALE: | N.T.S. |
| DWG. BY: | JK |
| CHK. BY: | LFS |
| DRAWING NO.: | FL-14512.4 |
| SHEET | 5 OF 10 |

R:\Clients\IDP PERMANENT\A - Florida Product Approvals\FL-14512\C - Drawings\FL 14512 (2017)\FL-14512.4.dwg, 6.1

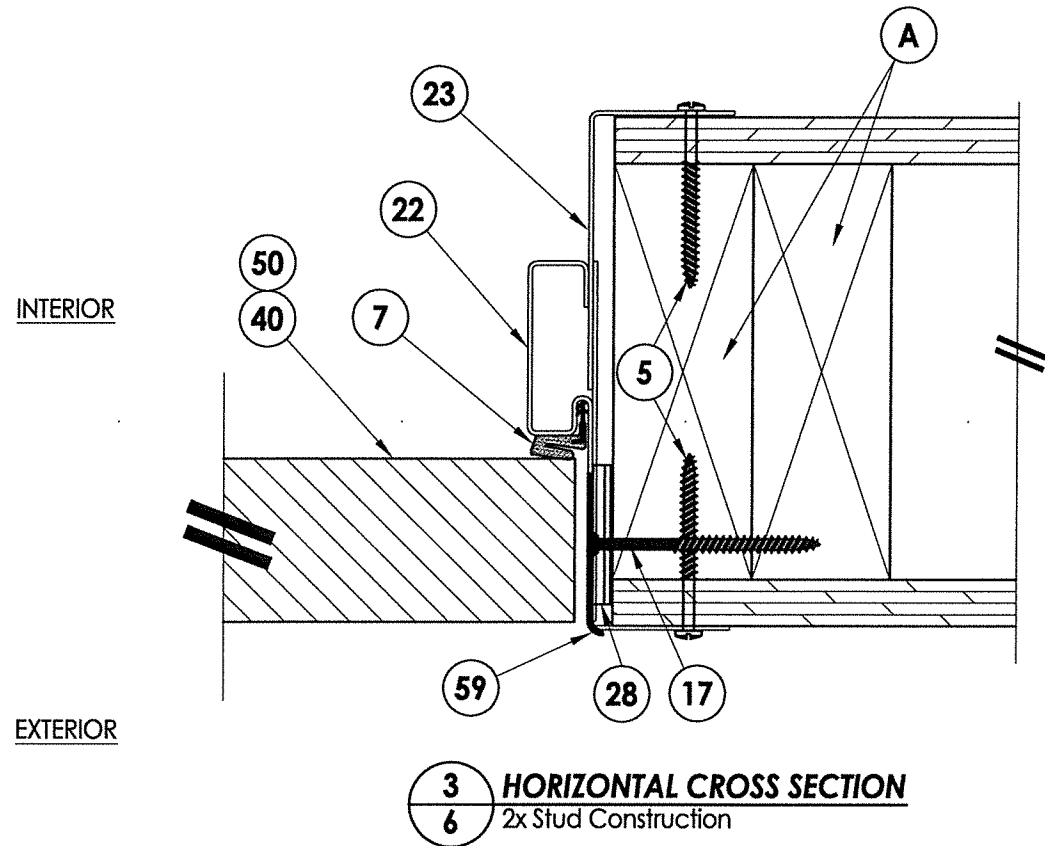
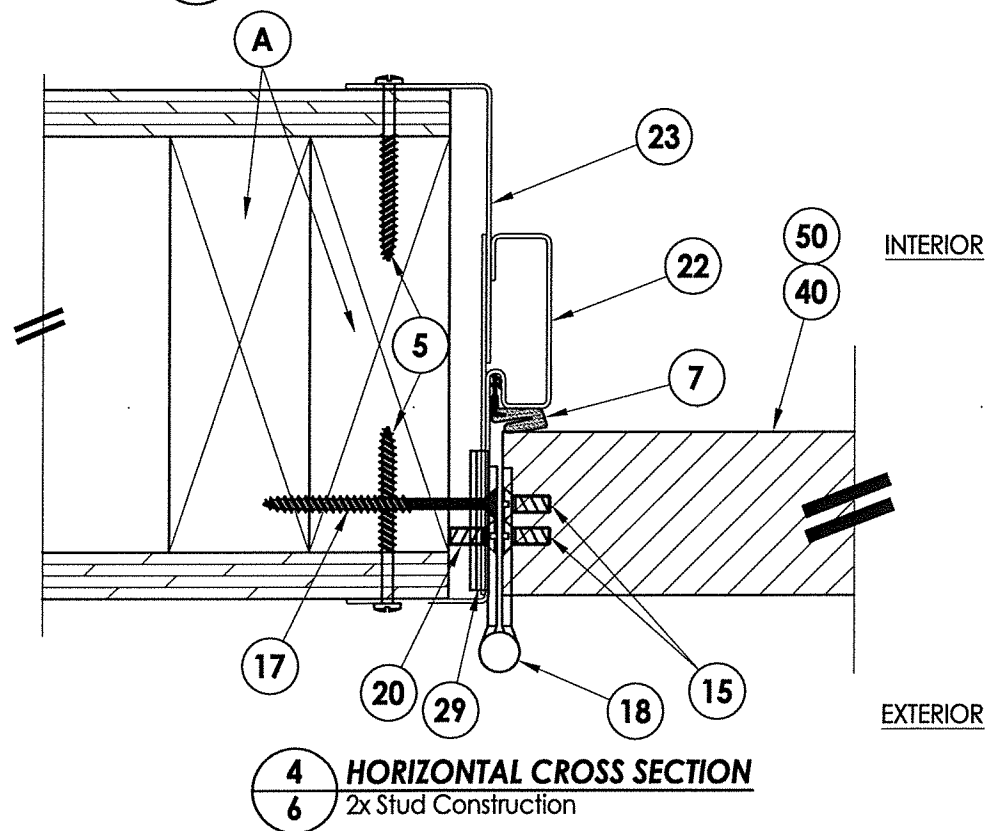
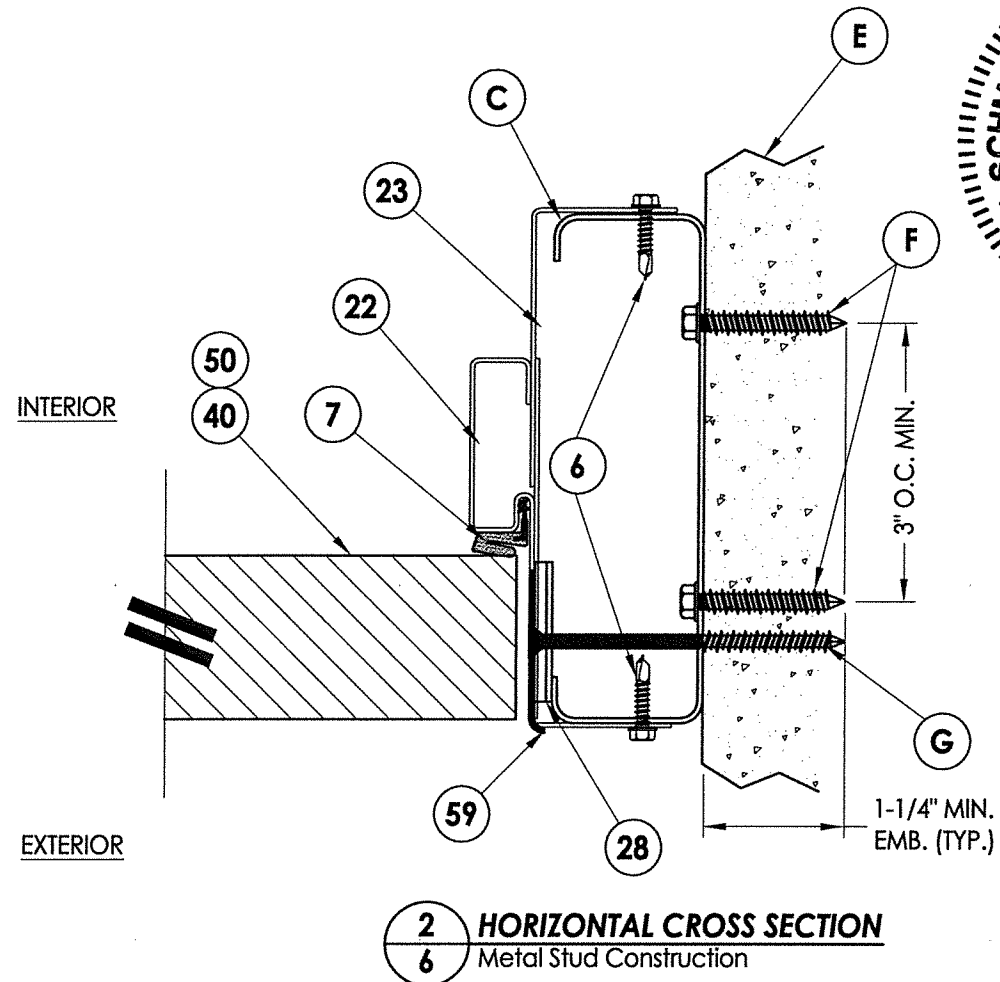
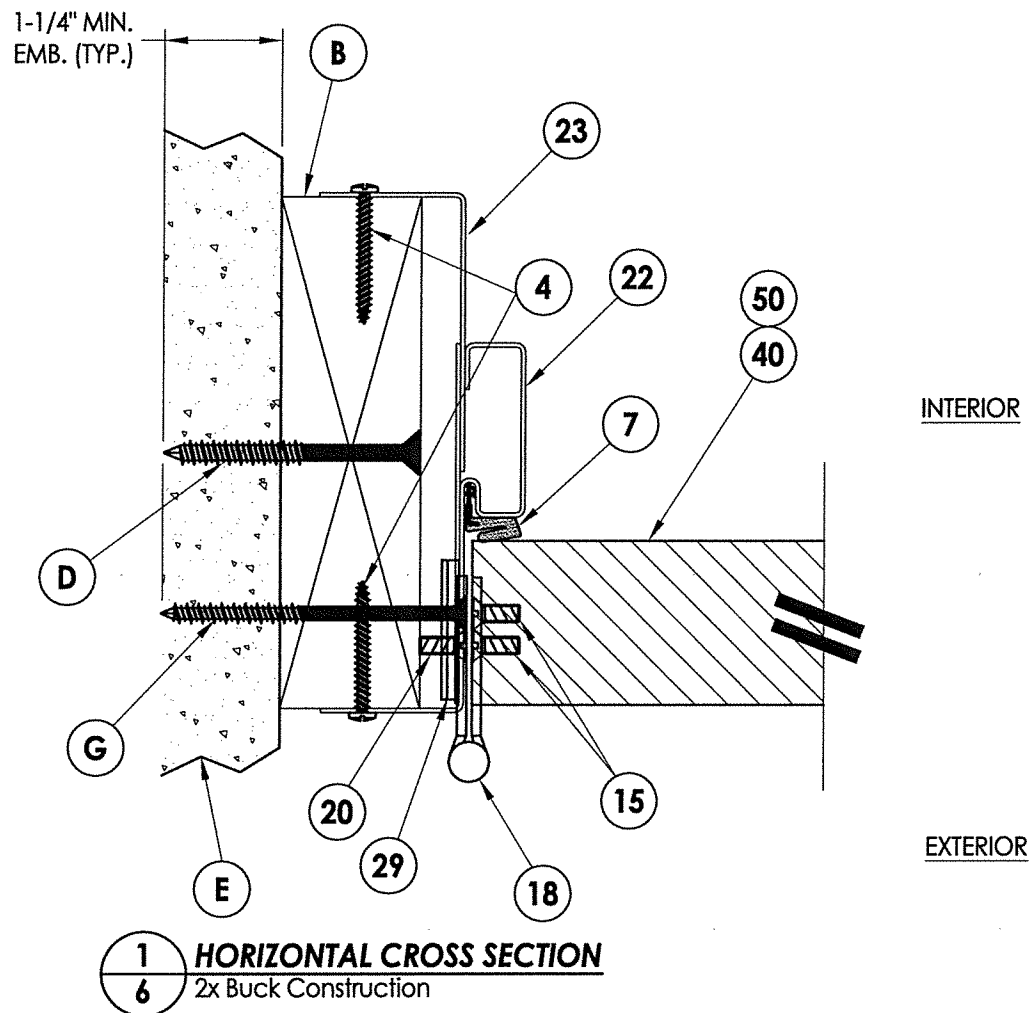

LFS
 5-6-17

Documents Prepared By: Lyndon F. Schmidt
 P.E. No. 43409
 STATE OF FLORIDA
 PROFESSIONAL ENGINEER
 License No. 43409

PRODUCT: IDP STEEL FRAME (K2A-SERIES)
 PART OR ASSEMBLY: HORIZONTAL CROSS SECTIONS

| NO. | DATE | REVISIONS | BY |
|-----|---------|------------------------------|-----|
| 3 | 5/06/19 | ADD SILL ANCHORING OPTION | LFS |
| 2 | 4/17/18 | CLARIFY FRAME ANCHORING | LFS |
| 1 | 9/26/17 | UPDATE TO 6TH ED. (2017) FBC | JK |

DATE: 10/23/15
 SCALE: N.T.S.
 DWG. BY: JK
 CHK. BY: LFS
 DRAWING NO.: FL-14512.4
 SHEET 6 OF 10

R.W. BUILDING CONSULTANTS, INC.
 P.O. Box 230, Valrico, FL 33595
 Phone No.: 813.659.9197
 FBPE C.A. No. 9813

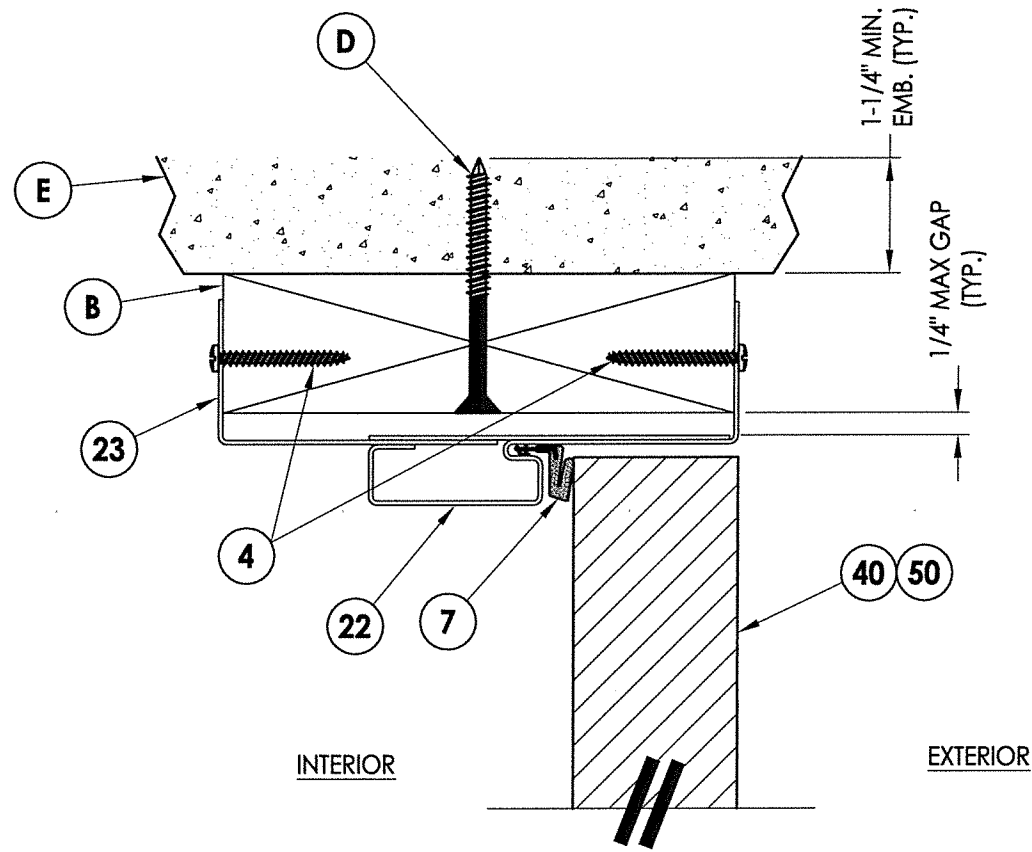

1
7 **VERTICAL CROSS SECTION**
Outswing

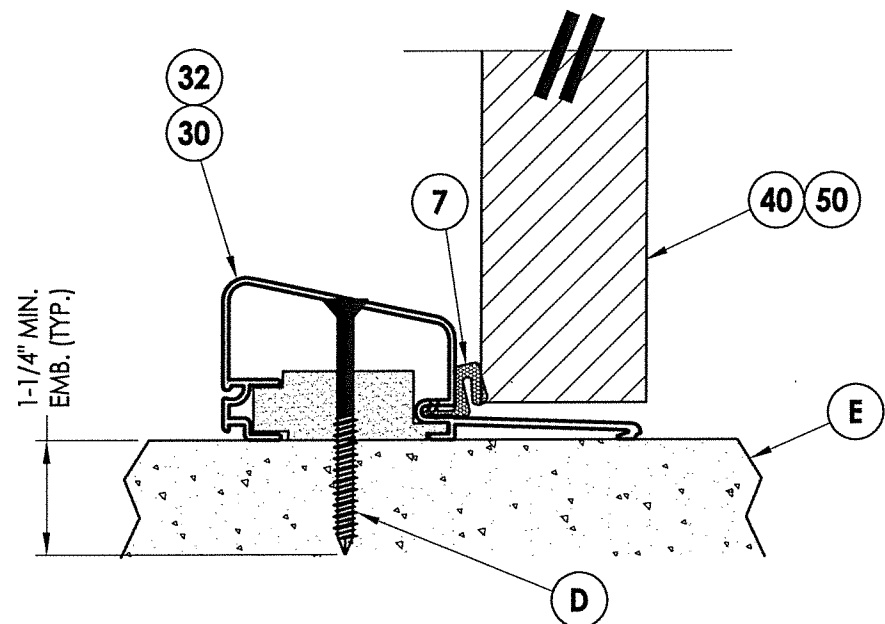

OPTIONAL FOR OUTSWING SILLS
(SEE DETAIL SHEET 9)

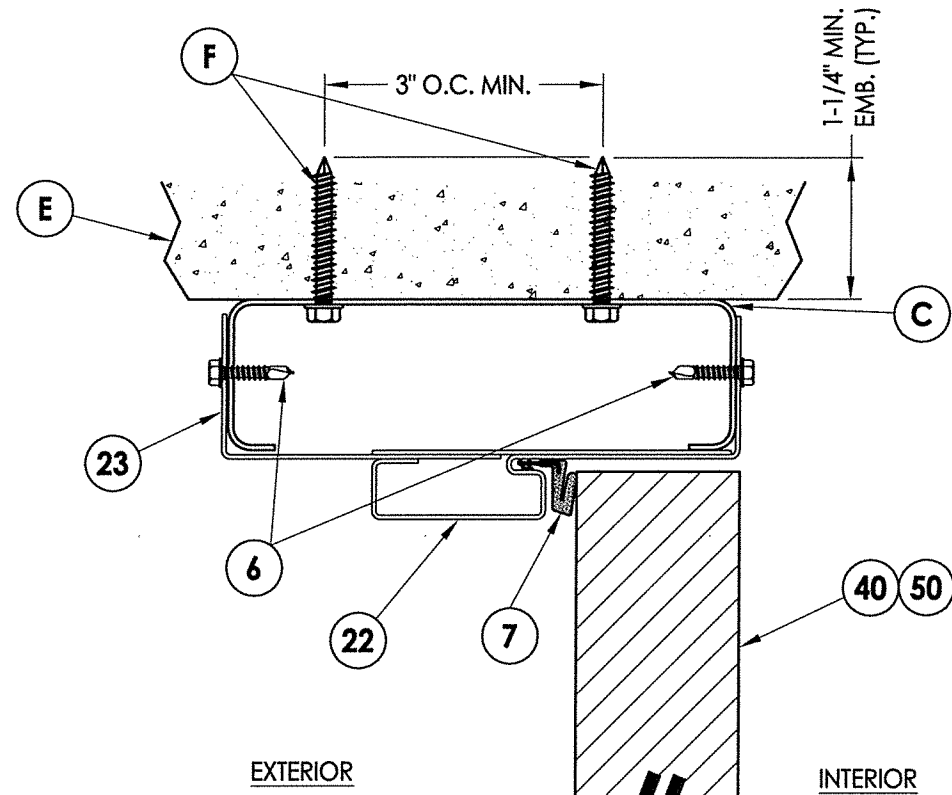

2
7 **VERTICAL CROSS SECTION**
Inswing

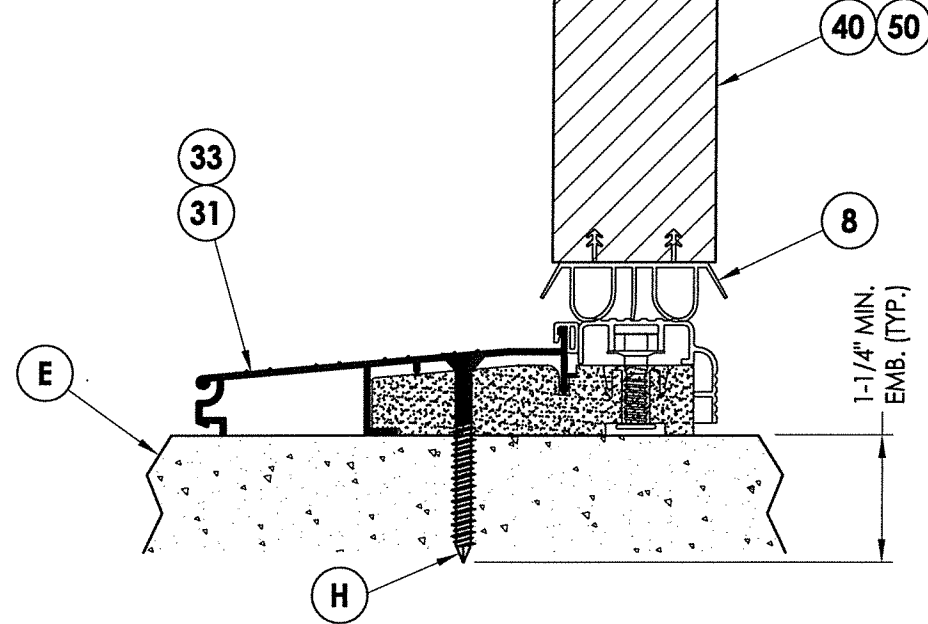

OPTIONAL FOR INSWING OR ADA SILLS
(SEE DETAIL SHEET 9)

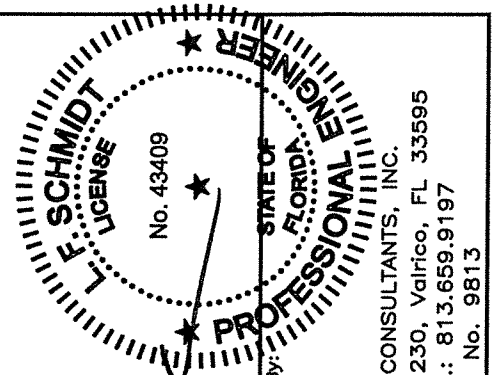

Documents Prepared By:
Lyndon F. Schmidt
P.E. No. 43409
RW BUILDING CONSULTANTS, INC.
P.O. Box 230, Valrico, FL 33595
Phone No.: 813.659.9197
FBPE C.A. No. 9813

PRODUCT: IDP STEEL FRAME (K2A-SERIES)
PART OR ASSEMBLY: VERTICAL CROSS SECTIONS

| NO. | DATE | REVISIONS | BY |
|-----|---------|------------------------------|-----|
| 3 | 5/06/19 | ADD SILL ANCHORING OPTION | LFS |
| 2 | 4/17/18 | CLARIFY FRAME ANCHORING | LFS |
| 1 | 9/26/17 | UPDATE TO 6TH ED. (2017) FBC | JK |

DATE: 10/23/15
SCALE: N.T.S.
DWG. BY: JK
CHK. BY: LFS
DRAWING NO.: FL-14512.4
SHEET 7 OF 10

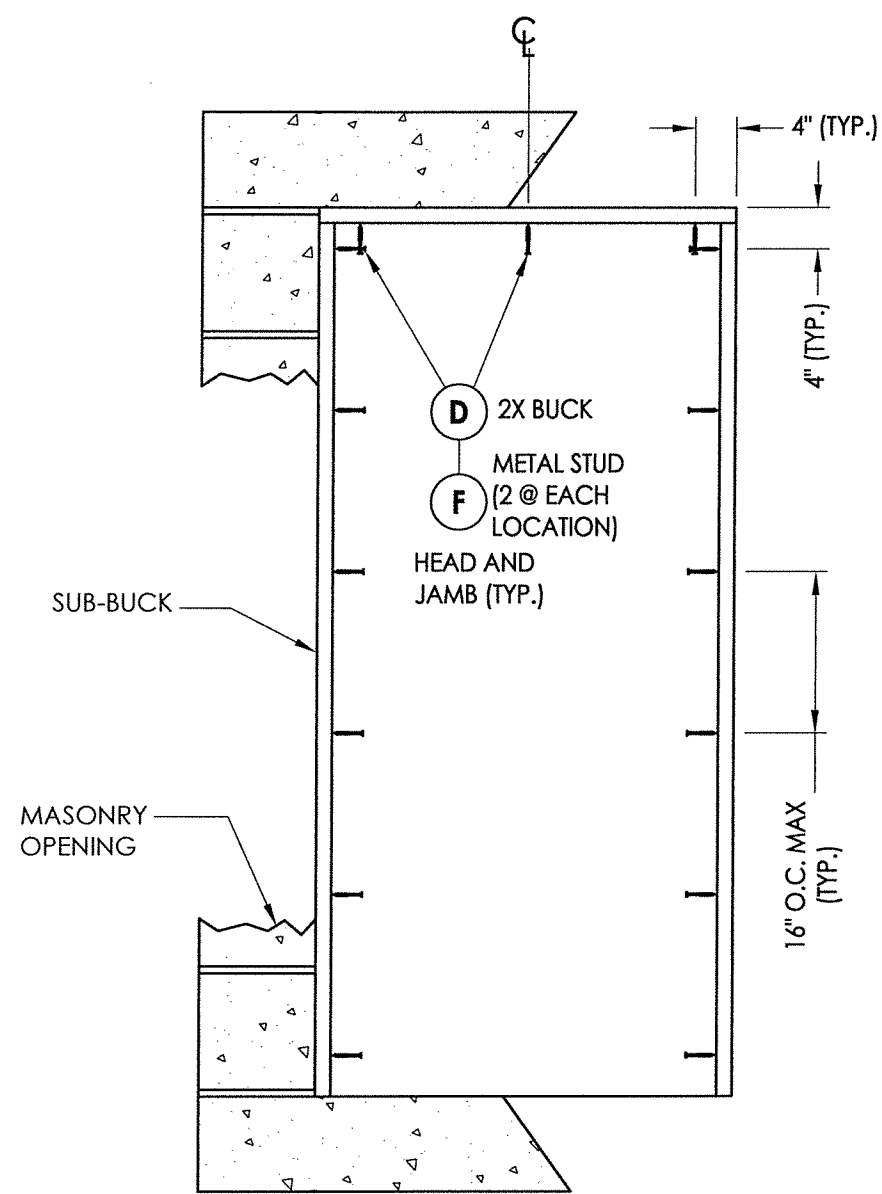

BUCK ANCHORING
7' Door

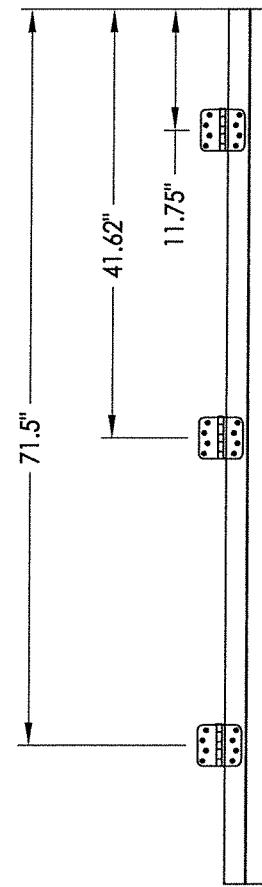

HINGE JAMB

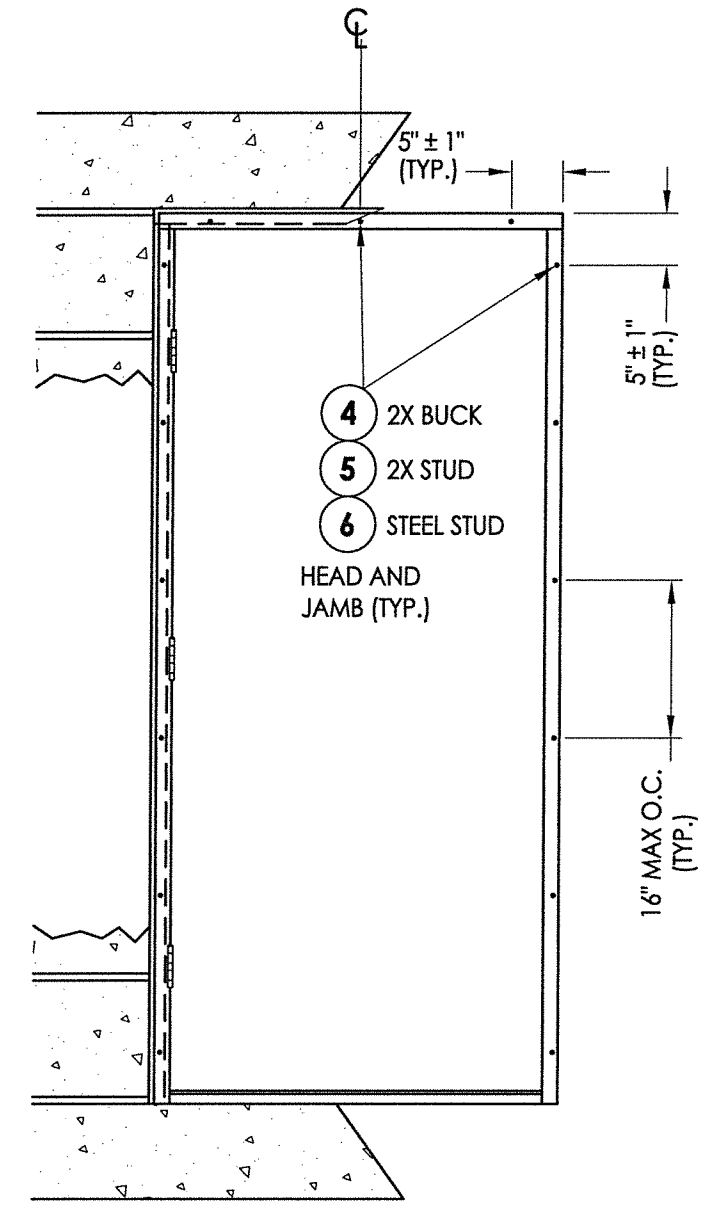

FRAME ANCHORING
7' Door

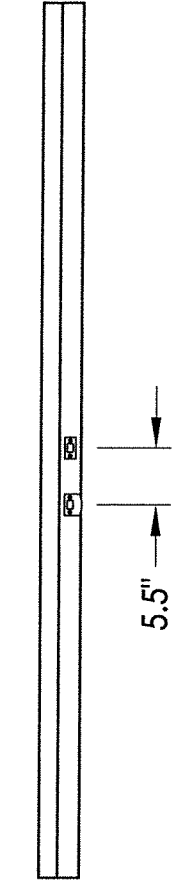

STRIKE JAMB

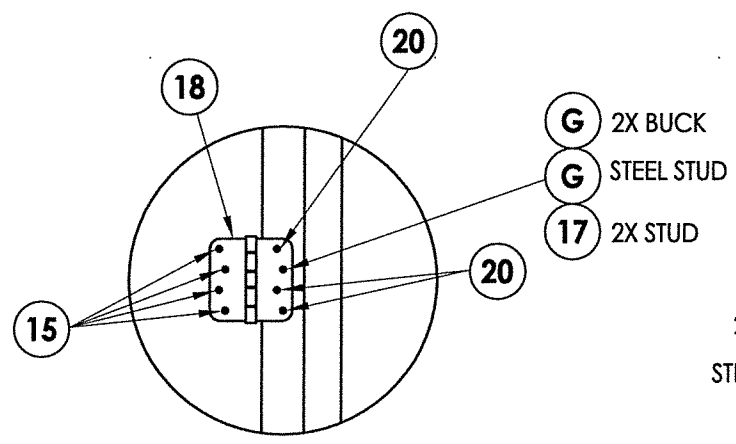

HINGE DETAIL

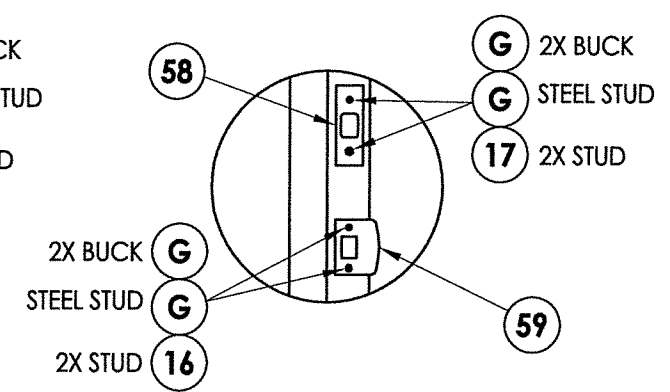

STRIKE PLATE DETAIL

CONCRETE ANCHOR NOTES:

1. Concrete anchor locations at the corners may be adjusted to maintain the min. edge distance to mortar joints.
2. Concrete anchor locations noted as "MAX. ON CENTER" must be adjusted to maintain the min. edge distance to mortar joints, additional concrete anchors may be required to ensure the "MAX. ON CENTER" dimension are not exceeded.
3. Concrete anchor table:

| ANCHOR TYPE | ANCHOR SIZE | MIN. EMBEDMENT | MIN. CLEARANCE TO MASONRY EDGE | MIN. CLEARANCE TO ADJACENT ANCHOR |
|----------------|-------------|----------------|--------------------------------|-----------------------------------|
| ITW TAPCON® | 1/4" | 1-1/4" | 2" | 4" |
| ELCO ULTRACON® | 1/4" | 1-1/4" | 1" | 4" |
| ITW TAPCON® | 3/16" | 1-1/4" | 3" | 1-1/2" |

WOOD SCREW INSTALLATION NOTES:

1. Maintain a minimum 5/8" edge distance, 1" end distance, & 1" o.c. spacing of wood screws to prevent the splitting of wood.

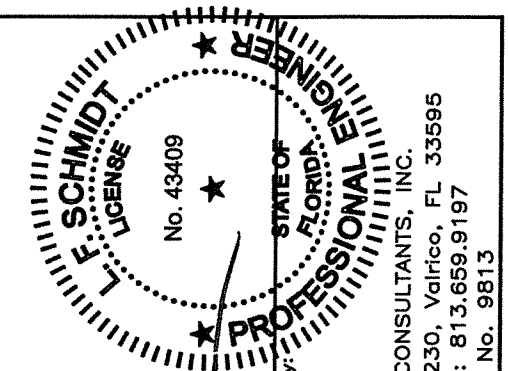

LFS
5.6.19

Documents Prepared By:
Lyndon F. Schmidt
P.E. No. 43409

RW
BUILDING CONSULTANTS, INC.
P.O. Box 230, Valrico, FL 33595
Phone No.: 813.659.9197
FBPE C.A. No. 9813

PRODUCT:
IDP
STEEL FRAME (K2A-SERIES)
PART OR ASSEMBLY:
FRAME AND BUCK ANCHORING (7'-0" DOOR)

| NO. | DATE | BY | REVISIONS |
|-----|---------|-----|------------------------------|
| 3 | 5/06/19 | LFS | ADD SILL ANCHORING OPTION |
| 2 | 4/17/18 | LFS | CLARIFY FRAME ANCHORING |
| 1 | 9/26/17 | JK | UPDATE TO 6TH ED. (2017) FBC |

DATE: 10/23/15
SCALE: N.T.S.
DWG. BY: JK
CHK. BY: LFS
DRAWING NO.: FL-14512.4
SHEET 8 OF 10

R:\Clients\DP PERMANENT\A - Florida Product Approvals\FL-14512\Drawings\FL 14512 (2017)\FL-14512.4.dwg, 9.1

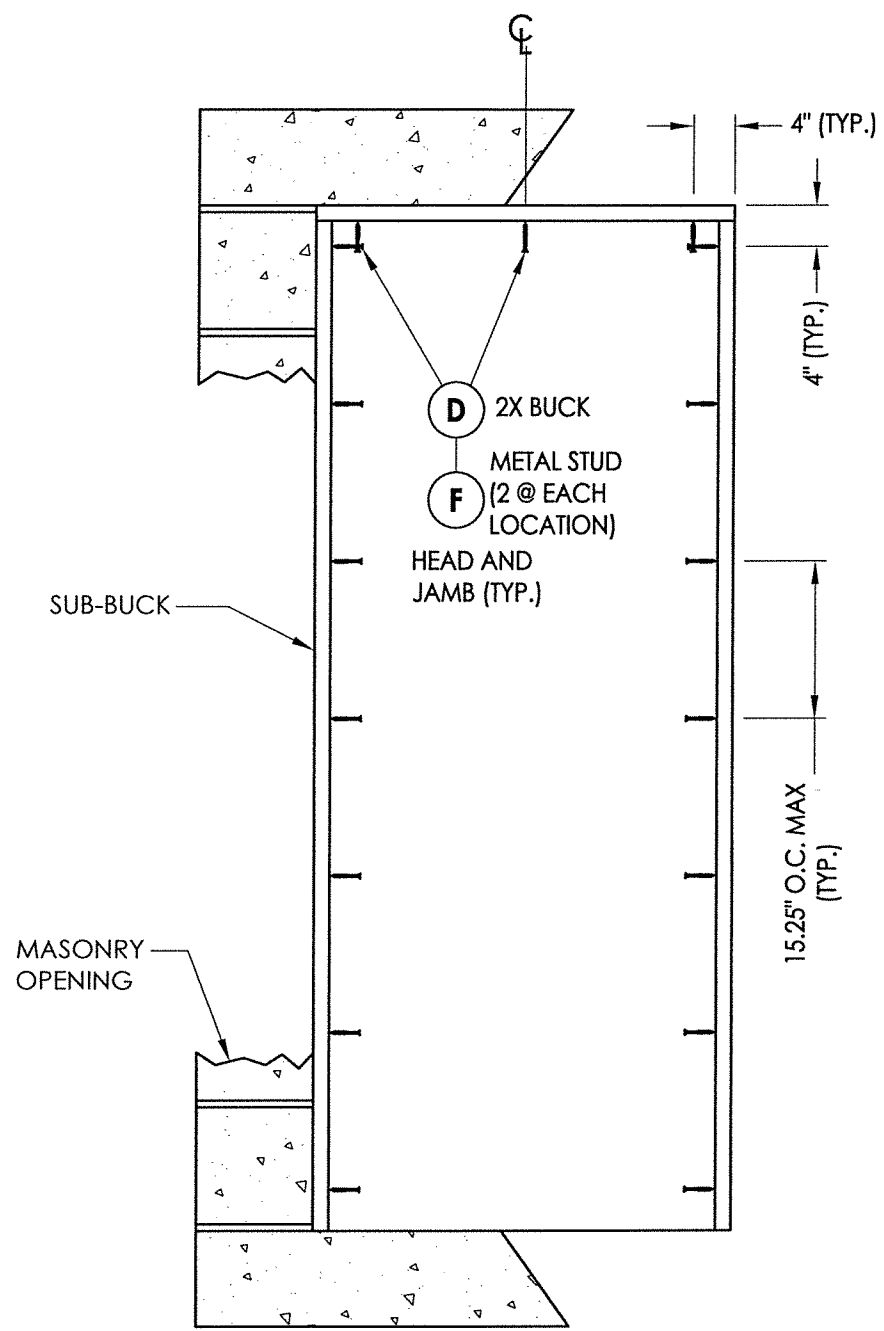

BUCK ANCHORING
8' Door

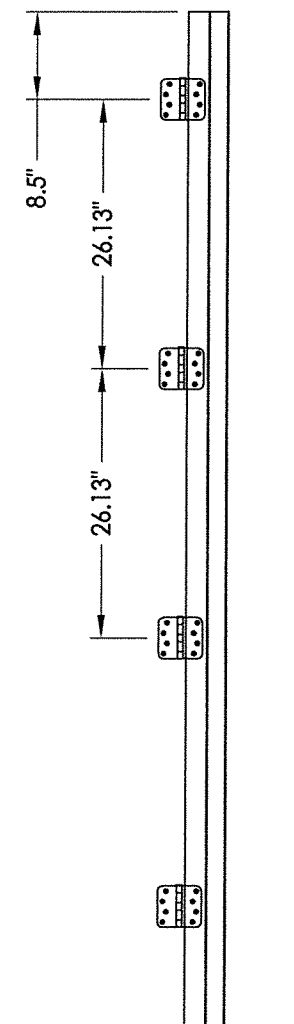

HINGE JAMB

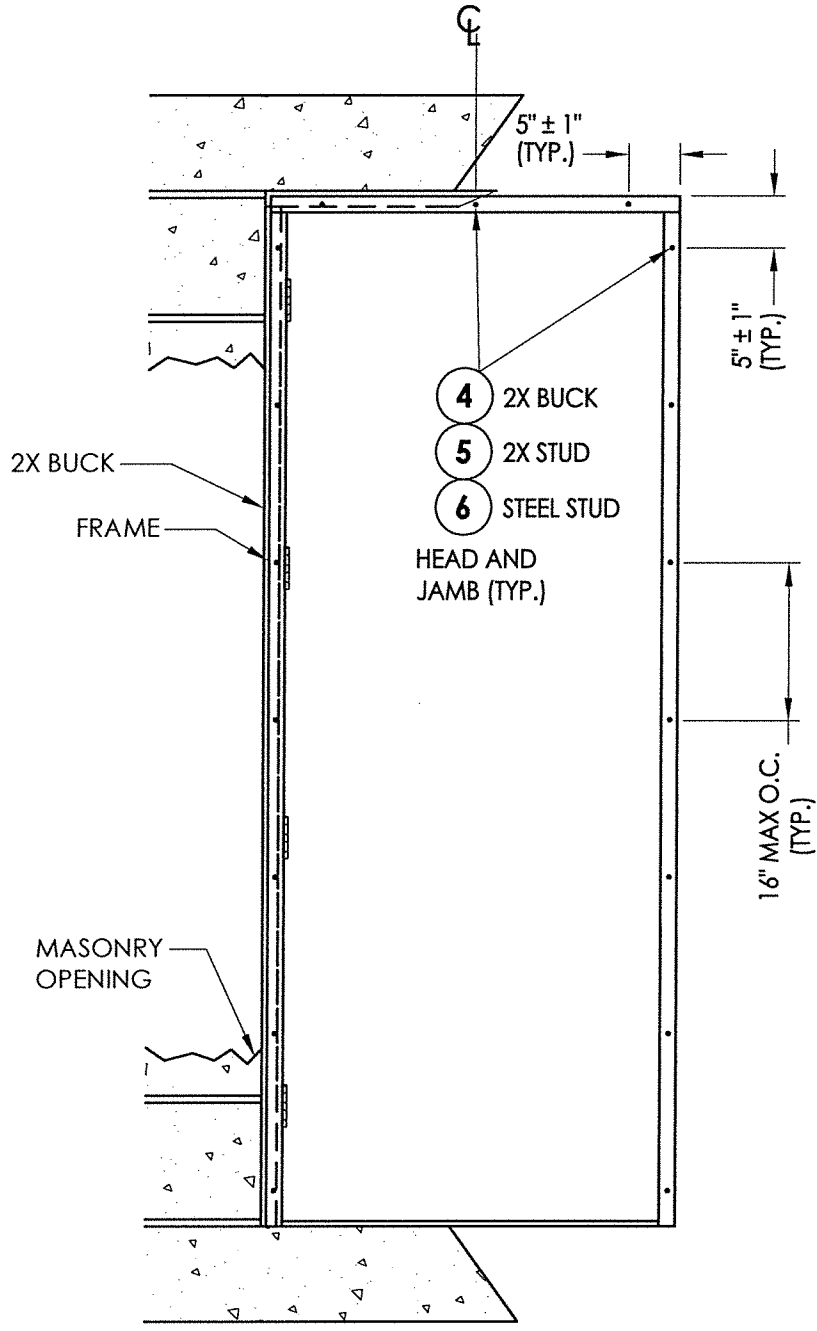

FRAME ANCHORING
8' Door

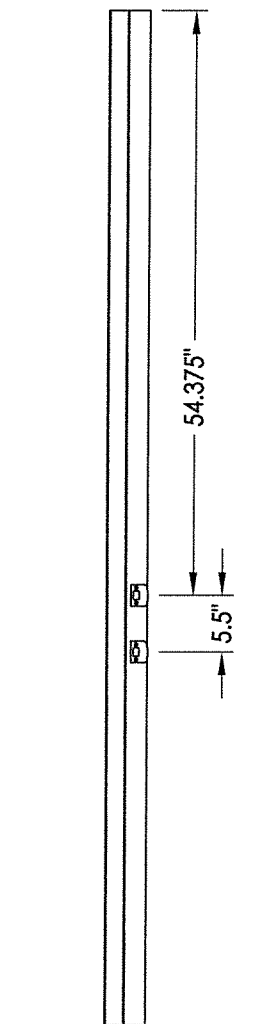

STRIKE JAMB

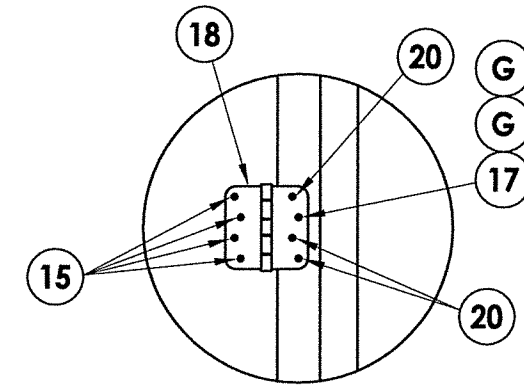

HINGE DETAIL

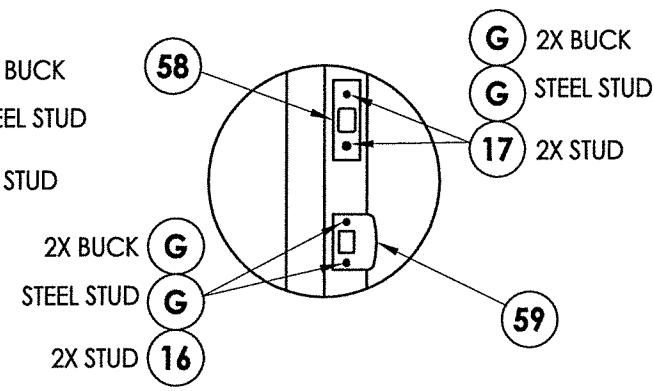

STRIKE PLATE DETAIL

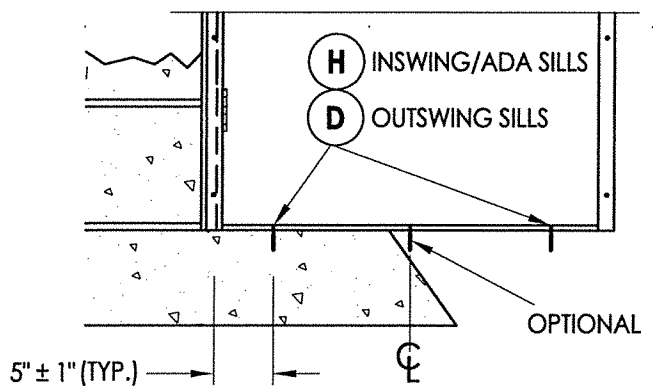

OPTIONAL SILL ANCHORING
IN LIEU OF FRAME CORNER CONNECTIONS
(SEE CORNER DETAIL - SHEET 4)

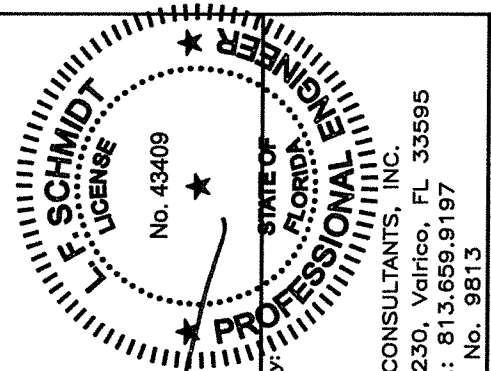

LFS
5.6.19

Documents Prepared By: **Lyndon F. Schmidt**
P.E. No. 43409
RW BUILDING CONSULTANTS, INC.
P.O. Box 230, Valrico, FL 33595
Phone No.: 813.659.9197
FBPE C.A. No. 9813

PRODUCT: IDP STEEL FRAME (K2A-SERIES)
PART OR ASSEMBLY: FRAME AND BUCK ANCHORING (8'-0" DOOR)

| NO. | DATE | BY | REVISIONS |
|-----|---------|-----|------------------------------|
| 3 | 5/06/19 | LFS | ADD SILL ANCHORING OPTION |
| 2 | 4/17/18 | LFS | CLARIFY FRAME ANCHORING |
| 1 | 9/26/17 | JK | UPDATE TO 6TH ED. (2017) FBC |

DATE: 10/23/15
SCALE: N.T.S.
DWG. BY: JK
CHK. BY: LFS
DRAWING NO.: FL-14512.4
SHEET 9 OF 10

R:\Clients\IDP PERMANENT\A - Florida Product Approvals\FL-14512C - Drawings\FL-14512.4.dwg, 10.1

BILL OF MATERIALS

| ITEM # | DESCRIPTION | MATERIAL |
|--------|---|-----------|
| A | 2X STUD FRAMING (SG>= 0.55) | WOOD |
| B | 2X BUCK (SG >= 0.55) | WOOD |
| C | METAL STUD (SSMA STUD 550S162-54, Fy = 33 ksi, Fu = 45 ksi) | STEEL |
| D | 1/4" X 2-3/4" ELCO OR ITW PFH CONCRETE SCREW | STEEL |
| E | MASONRY - 3,000 PSI MIN. CONCRETE CONFORMING TO ACI 301 OR HOLLOW BLOCK CONFORMING TO ASTM C90 OR ASTM A653 STEEL | CONCRETE |
| F | 3/16" X 1-3/4" HWH ITW CONCRETE SCREW | STEEL |
| G | 3/16" X 3-1/4" ELCO OR ITW PFH CONCRETE SCREW | STEEL |
| H | 1/4" X 2-1/4" ELCO OR ITW PFH CONCRETE SCREW | STEEL |
| 4 | #10 X 1-1/2" PPH SMS (1-1/4" MIN. EMBEDMENT) | STEEL |
| 5 | #10 X 2" PPH SMS (1-1/4" MIN. EMBEDMENT) | STEEL |
| 6 | #10 X 3/4" HWH SELF-DRILLING TEK SCREW (3 THREADS MUST PROTRUDE THRU STEEL) | STEEL |
| 7 | COMPRESSION WEATHERSTRIPPING QLON QDS 650 BY SCHLEGEL | - |
| 8 | SWEEP | PVC |
| 15 | 10-24 X 5/8" PFH MS | STEEL |
| 16 | #8 X 2-1/2" PFH WS | STEEL |
| 17 | #10 X 2-1/2" PFH WS | STEEL |
| 18 | 4.0" X 4.0" HINGE | STEEL |
| 19 | 8-32 X 3/8" PFH MS | STEEL |
| 20 | 10-24 X 1/2" PFH MS | STEEL |
| 22 | IDP (K2A-SERIES) EXTERIOR FRAME (18 GA. - A60 GALVANNEALED STEEL) | STEEL |
| 23 | IDP (K2A-SERIES) INTERIOR FRAME (22 GA. - A60 GALVANNEALED STEEL) | STEEL |
| 28 | HINGE LATCH AND DEADBOLT REINFORCEMENT | STEEL |
| 29 | HINGE REINFORCEMENT | STEEL |
| 30 | OUTSWING THRESHOLD | ALUM/WOOD |
| 31 | INSWING THRESHOLD | ALUM/COMP |
| 32 | OUTSWING THRESHOLD | ALUM/COMP |
| 33 | ADA THRESHOLD | ALUM |
| 40 | 8' DOOR - SEE DOOR PANEL DETAILS | - |
| 50 | 7' DOOR - SEE DOOR PANEL DETAILS | - |
| 58 | STRIKE PLATE - DEADBOLT | STEEL |
| 59 | " T " STRIKE PLATE - LATCH | STEEL |

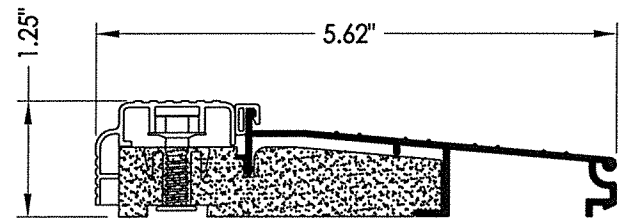

31 INSWING THRESHOLD
AFCO

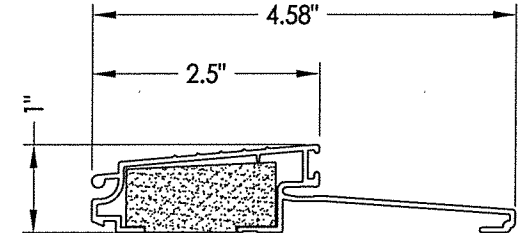

32 OUTSWING THRESHOLD
AFCO

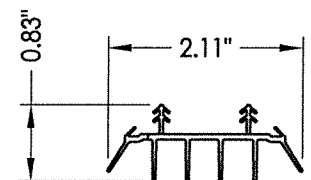

8 SWEEP

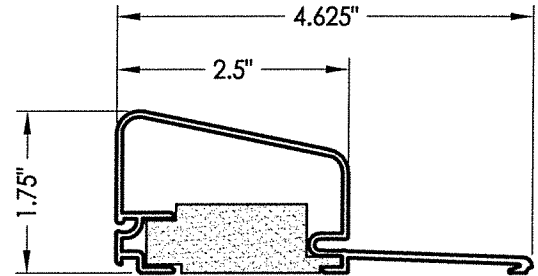

30 OUTSWING THRESHOLD
AFCO

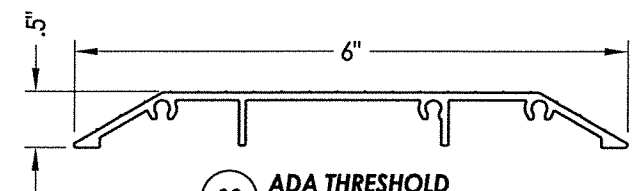

33 ADA THRESHOLD
AFCO A-202

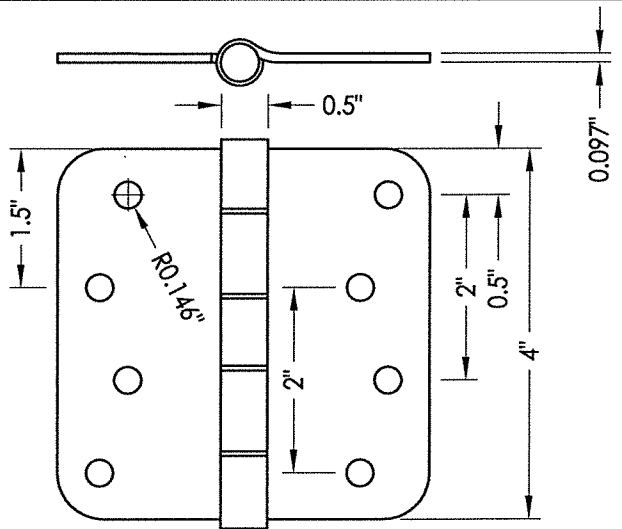

18 HINGE

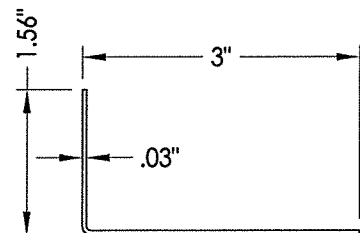

23 INTERIOR FRAME

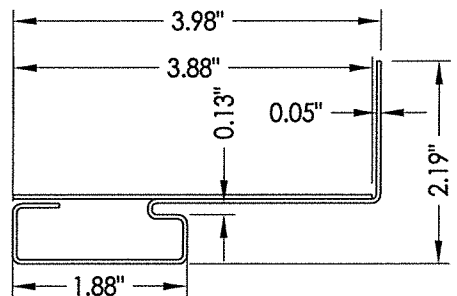

22 EXTERIOR FRAME

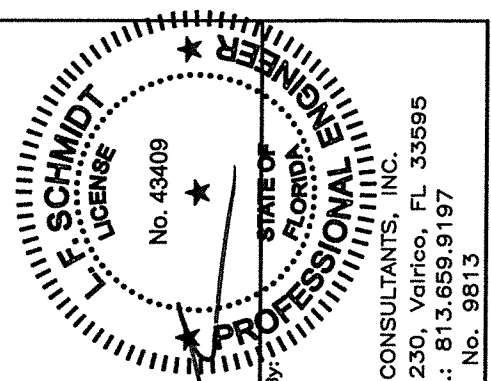

Documents Prepared By:
Lyndon F. Schmidt
P.E. No. 43409
LFS
5-6-19

PRODUCT:
IDP (K2A-SERIES)
STEEL FRAME (K2A-SERIES)
PART OR ASSEMBLY:
BILL OF MATERIALS AND COMPONENTS

| NO. | DATE | REVISIONS |
|-----|---------|------------------------------|
| 3 | 5/06/19 | ADD SILL ANCHORING OPTION |
| 2 | 4/17/18 | CLARIFY FRAME ANCHORING |
| 1 | 9/26/17 | UPDATE TO 6TH ED. (2017) FBC |

DATE: 10/23/15
SCALE: N.T.S.
DWG. BY: JK
CHK. BY: LFS
DRAWING NO.: FL-14512.4
SHEET 10 of 10